

**REPAIR PARTS MANUAL**  
**MODEL NO. JR6N21CHE**  
**Rotary Lawn Mower**

---

***PARTNER***

ROTARY LAWN MOWER -- MODEL NUMBER JR6N21CHE

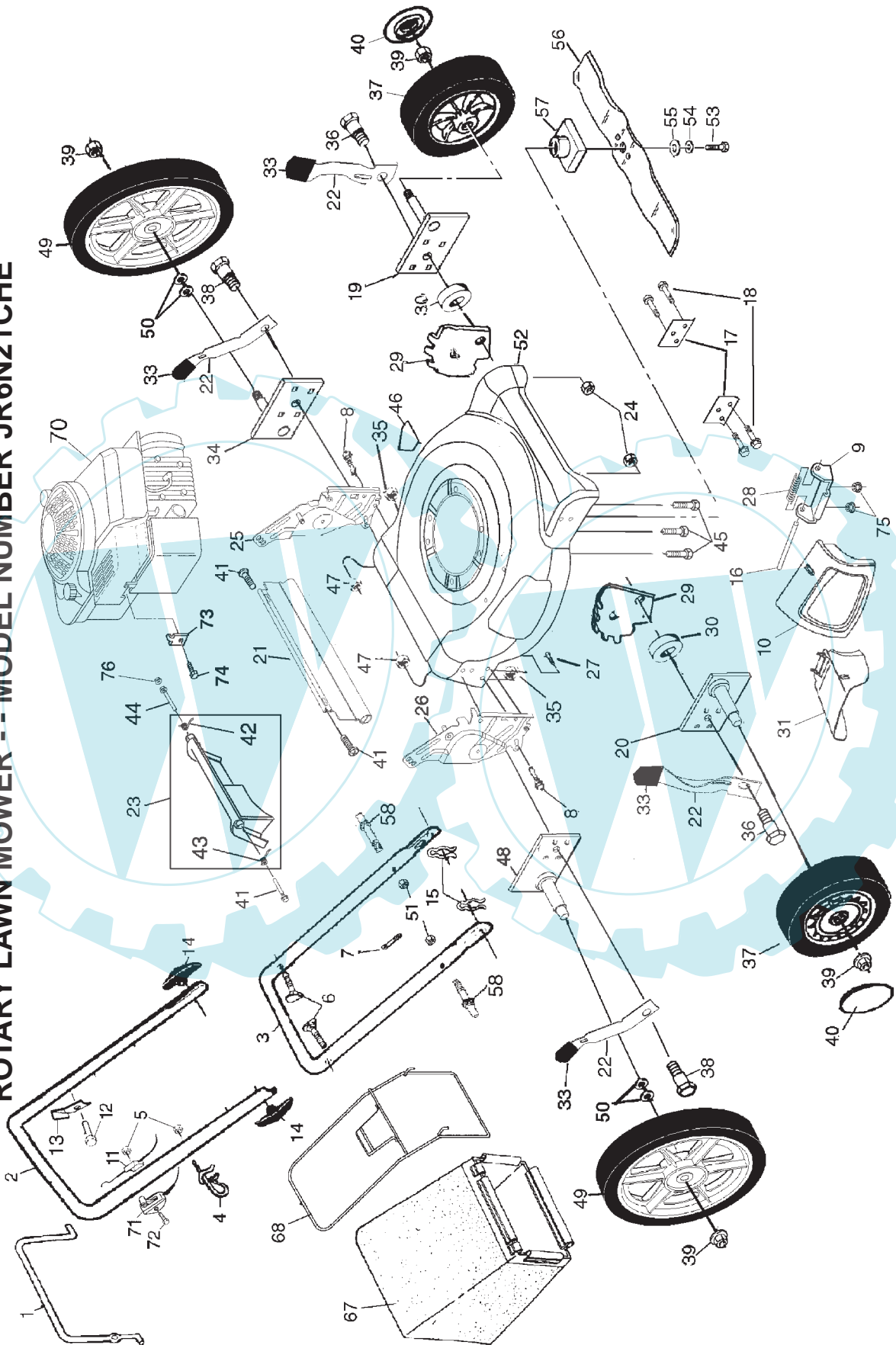

# ROTARY LAWN MOWER --- MODEL NUMBER JR6N21CHE

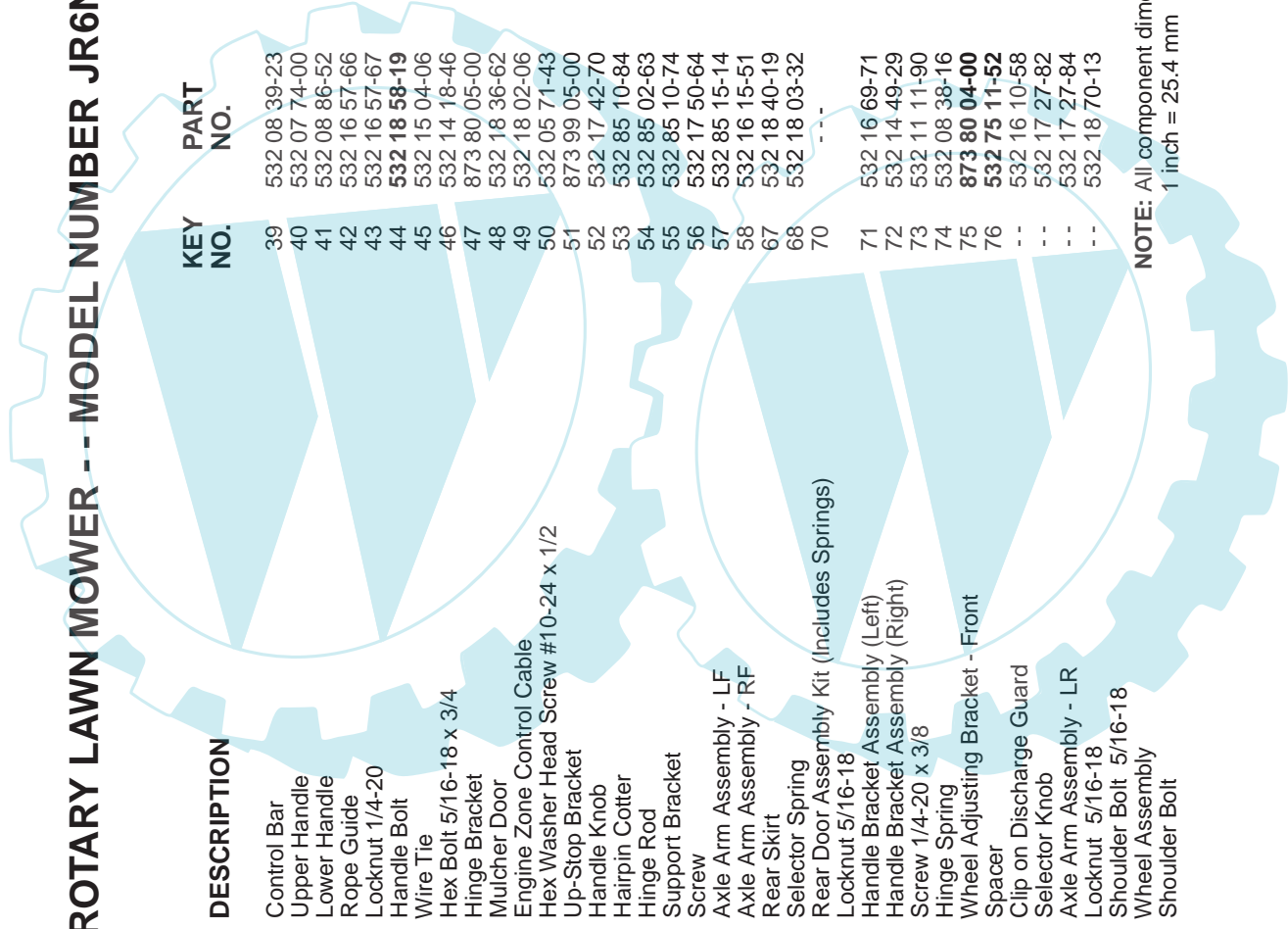

| KEY NO. | PART NO.            | DESCRIPTION                               | KEY NO. | PART NO.            | DESCRIPTION   |
|---------|---------------------|---|---------|---------------------|---|
| 1       | 532 13 16-96        | Control Bar                               | 39      | 532 08 39-23        | Flanged Locknut   |
| 2       | 532 17 76-98        | Upper Handle                              | 40      | 532 07 74-00        | Hubcap  |
| 3       | 532 16 45-56        | Lower Handle                              | 41      | 532 08 86-52        | Hinge Screw   |
| 4       | 532 17 95-85        | Rope Guide                                | 42      | 532 16 57-66        | Spring (LH)   |
| 5       | 532 13 20-04        | Locknut 1/4-20                            | 43      | 532 16 57-67        | Spring (RH)   |
| 6       | 532 13 19-59        | Handle Bolt                               | 44      | <b>532 18 58-19</b> | Door Bolt   |
| 7       | 532 06 64-26        | Wire Tie                                  | 45      | 532 15 04-06        | Hex Head Thread Rolling Screw 3/8-16 x 1  |
| 8       | 874 78 05-12        | Hex Bolt 5/16-18 x 3/4                    | 46      | 532 14 18-46        | Danger Decal  |
| 9       | 532 15 41-32        | Hinge Bracket                             | 47      | 873 80 05-00        | Nut   |
| 10      | 532 16 57-54        | Mulcher Door                              | 48      | 532 18 36-62        | Axle Arm Assembly - RR  |
| 11      | 532 13 31-07        | Engine Zone Control Cable                 | 49      | 532 18 02-06        | Wheel   |
| 12      | <b>532 75 06-34</b> | Hex Washer Head Screw #10-24 x 1/2        | 50      | 532 05 71-43        | Wave Washer   |
| 13      | 532 12 51-62        | Up-Stop Bracket                           | 51      | 873 99 05-00        | Nut   |
| 14      | 532 13 63-76        | Handle Knob                               | 52      | 532 17 42-70        | Housing Assembly (Includes Key #17, 18 & 46)  |
| 15      | 532 05 17-93        | Hairpin Cotter                            | 53      | 532 85 10-84        | Hex Head Screw 3/8-24 x 1-3/8 Grade 8   |
| 16      | 532 14 72-86        | Hinge Rod                                 | 54      | 532 85 02-63        | Helical Lockwasher  |
| 17      | 532 17 41-12        | Support Bracket                           | 55      | 532 85 10-74        | Hardened Washer   |
| 18      | 817 60 04-06        | Screw                                     | 56      | 532 17 50-64        | 21" Blade   |
| 19      | 532 16 86-05        | Axle Arm Assembly - LF                    | 57      | 532 85 15-14        | Blade Adapter   |
| 20      | 532 16 86-04        | Axle Arm Assembly - RF                    | 58      | 532 16 15-51        | Adjustment Bolt   |
| 21      | 532 16 58-58        | Rear Skirt                                | 67      | 532 18 40-19        | Grass Bag   |
| 22      | 532 16 85-99        | Selector Spring                           | 68      | 532 18 03-32        | Catcher Frame   |
| 23      | 532 16 68-75        | Rear Door Assembly Kit (Includes Springs) | 70      | ---                 | Engine, Briggs & Stratton, Model Number 12H802 (Order parts from engine manufacturer) |
| 24      | 873 93 05-00        | Locknut 5/16-18                           | 71      | 532 16 69-71        | Throttle Control  |
| 25      | <b>532 18 71-15</b> | Handle Bracket Assembly (Left)            | 72      | 532 14 49-29        | Screw   |
| 26      | <b>532 18 71-16</b> | Handle Bracket Assembly (Right)           | 73      | 532 11 11-90        | Clamp   |
| 27      | 532 85 18-56        | Screw 1/4-20 x 3/8                        | 74      | 532 08 38-16        | Screw   |
| 28      | 532 15 21-24        | Hinge Spring                              | 75      | <b>873 80 04-00</b> | Nut, Hex 1/4-20   |
| 29      | 532 16 57-04        | Wheel Adjusting Bracket - Front           | 76      | <b>532 75 11-52</b> | Nut, Hex, Flangelock 1/4-20   |
| 30      | 532 18 39-01        | Spacer                                    | --      | 532 16 10-58        | Warning Decal (Not Shown)   |
| 31      | 532 16 57-60        | Clip on Discharge Guard                   | --      | 532 17 27-82        | Operator's Manual(English)  |
| 33      | 532 08 78-77        | Selector Knob                             | --      | 532 17 27-84        | Operator's Manual(Spanish)  |
| 34      | 532 18 36-61        | Axle Arm Assembly - LR                    | --      | 532 18 70-13        | Replacement Parts Manual  |
| 35      | 532 16 67-85        | Locknut 5/16-18                           |         |                     |   |
| 36      | 532 16 08-28        | Shoulder Bolt 5/16-18                     |         |                     |   |
| 37      | 532 14 62-47        | Wheel Assembly                            |         |                     |   |
| 38      | 532 16 43-62        | Shoulder Bolt                             |         |                     |   |

**NOTE:** All component dimensions given in U.S. inches.  
1 inch = 25.4 mm

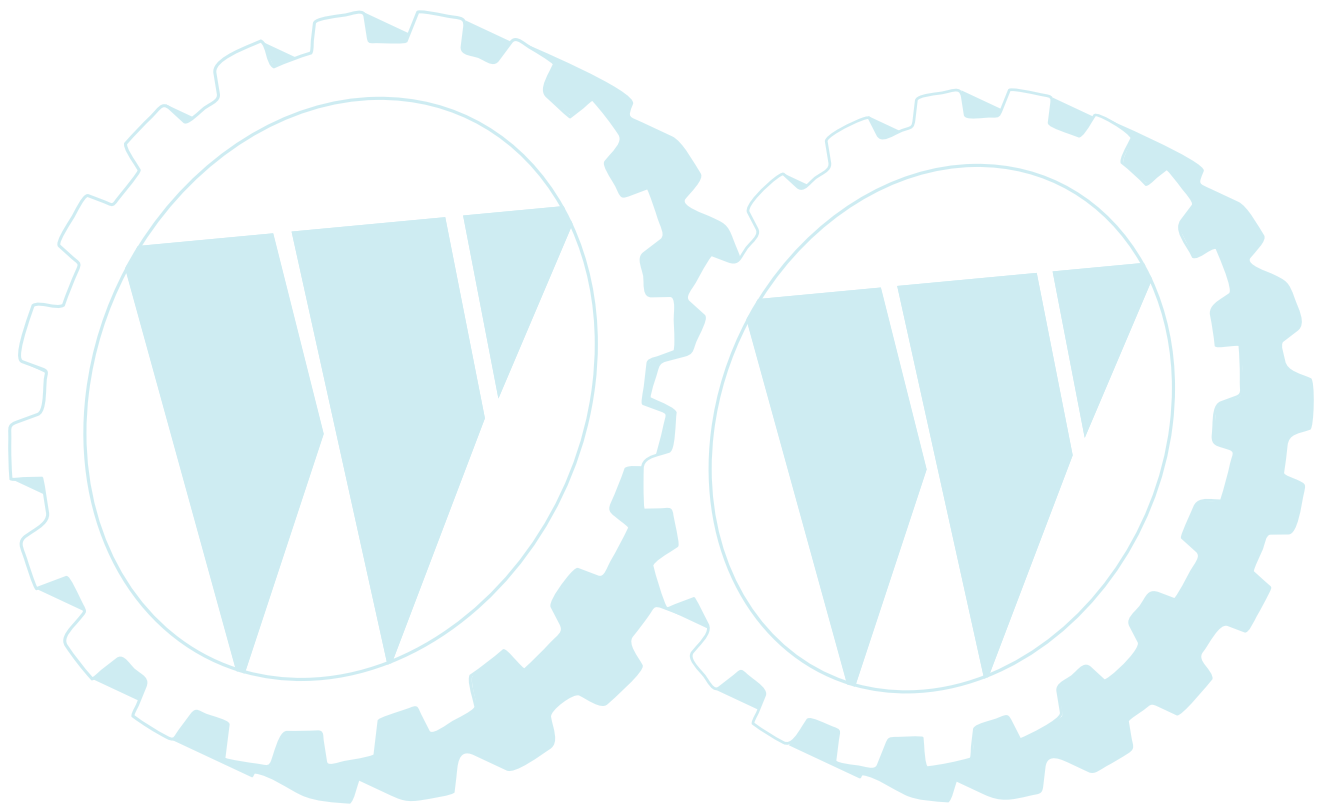

***PARTNER***

Ihr Ersatzteilspezialist im Internet